

TRADE OAK Building Kits

TRADITIONAL & MODERN
100% GREEN OAK FRAMES

B02

2 Bay Garage with 50° Gable End Roof
Supplied as a Building Kit in 100% Green Oak
(including Air Dried Oak Pegs).

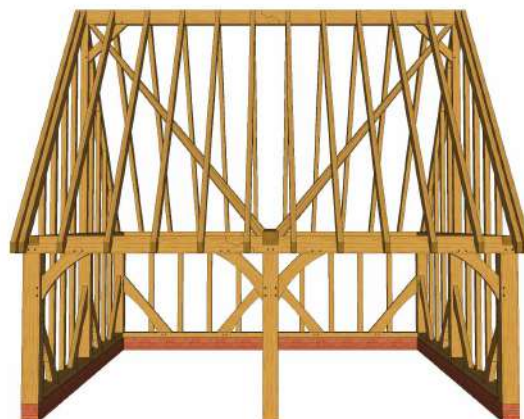

KIT SPECIFICATION

Dimensions include 230mm 3-course brick plinth

Height: 5995mm

Width: 6230mm

Depth: 6000mm

Roof Pitch: 50°

Oak Front Posts: 215mm x 195mm

Tie Beam: 275mm x 195mm

Oak Posts: 195mm x 195mm

Oak Head Plate: 220mm x 195mm

Oak Rafters: 150mm x 70mm

Timber Grade QP1 (D24)

DELIVERY & ASSEMBLY INFORMATION

Lifting equipment is strongly recommended

Lead-time: 4-6 weeks

Total Weight: 5900kg

Heaviest Component: 380kg

Longest Length: 6300mm

Total Volume: 4.9m³

Assembly Time: 2.5 days (3 man team)

Cladding Requirement*: 464 LM

Shingle Requirement*: 190m²

Batten Requirement*: 576 LM

**Calculated at our related product specifications*

B02

2 Bay Garage with 50° Gable End Roof

FRONT & REAR ELEVATION

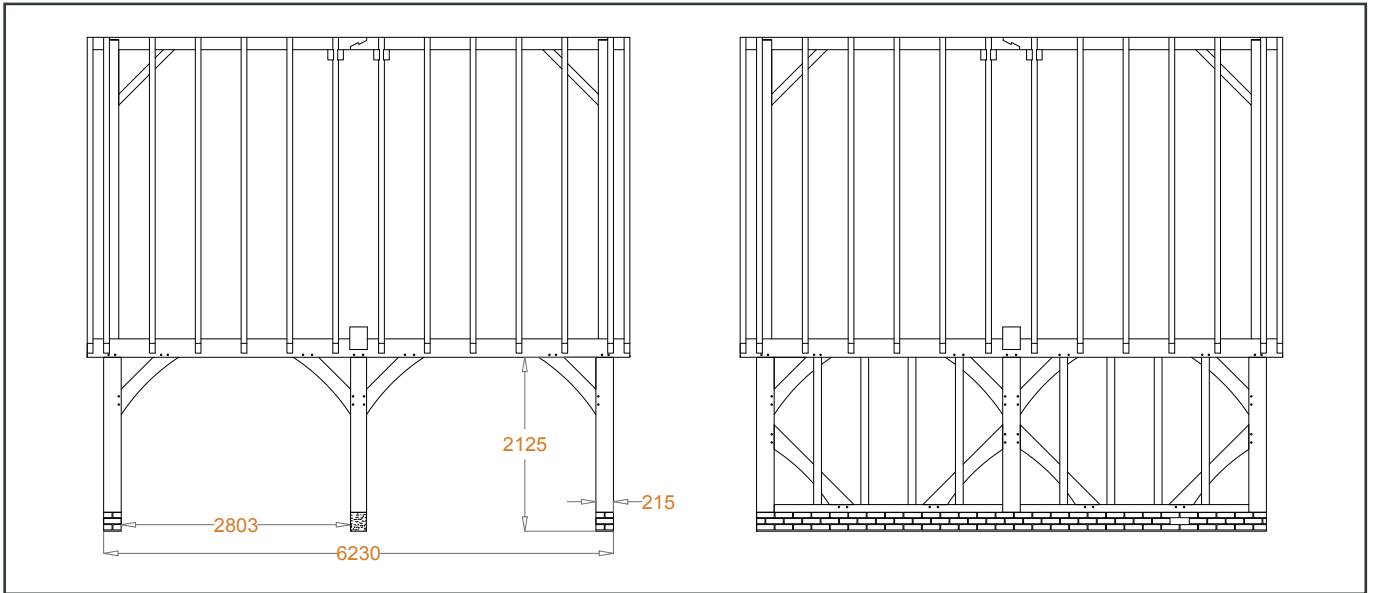

SIDE ELEVATION

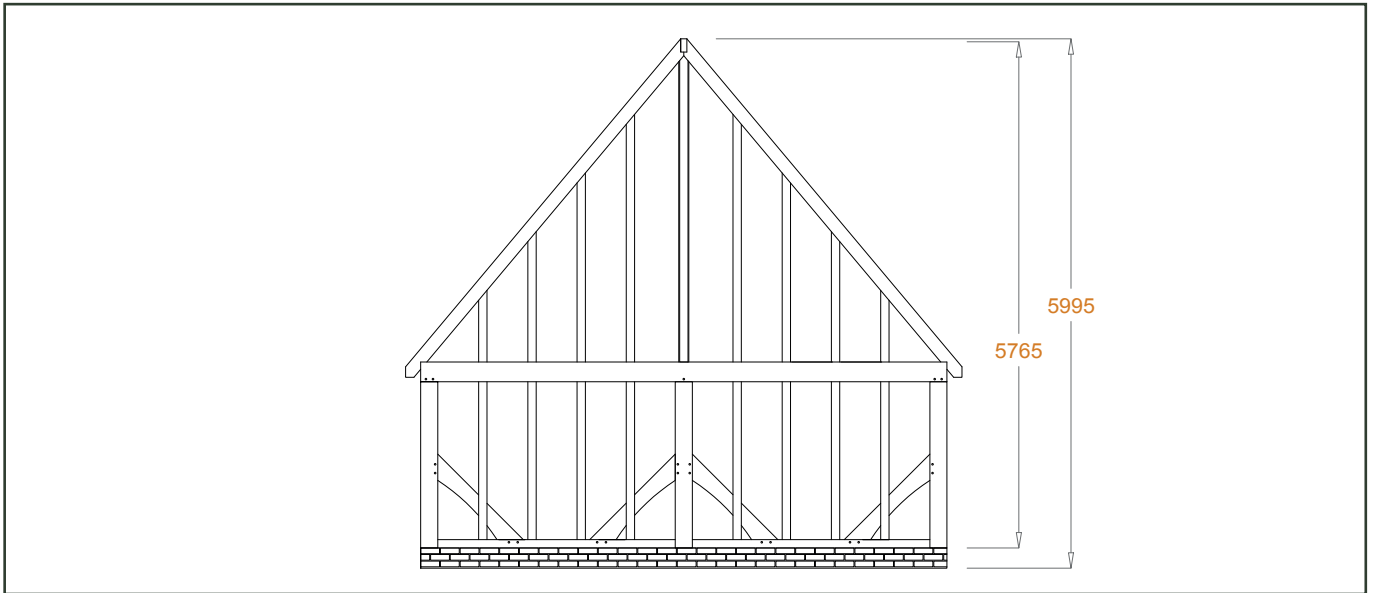

FLOOR PLAN

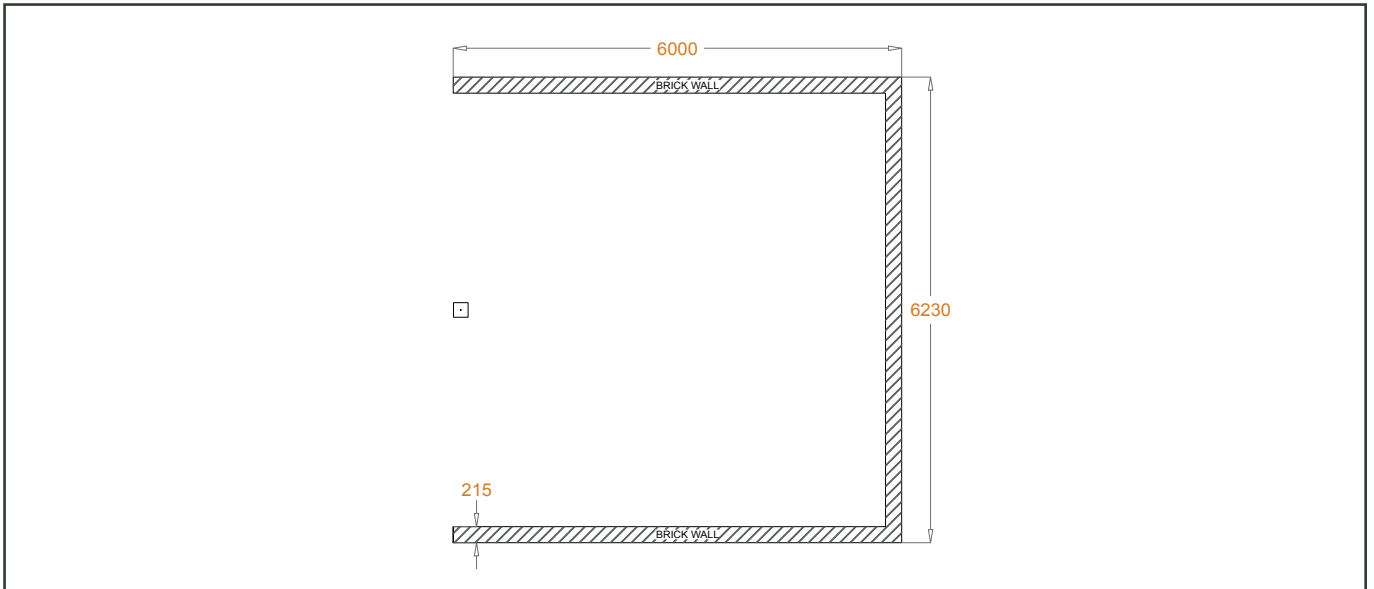

KEY FEATURES

What makes our kits better?



100% GREEN OAK

Unlike the majority of timber kits on the market, our products are made from 100% European Green Oak, including rafters and studwork. Not to be confused with the lower end of the market, we have aspired to recreate the detail and strength of a hand-crafted bespoke oak frame building as a pre-cut kit.



BRICK-WIDTH SOLEPLATE & UPRIGHTS

The uprights of our kits are 215mm, to match that of a standard brick size, ensuring the build is easier without custom bricks.

The beam integrates seamlessly with the brick plinth, so doors can be mounted directly.



EXTRA-WIDE BAYS

Extra-wide bays are a feature of all our garage kits. Most standard kits on a 2-bay feature a width of 5600mm; our kits are 6000mm.



HIGH QUALITY, LATEST TECHNOLOGY

Our innovative machinery is capable of transferring, qualitatively and cost effectively, our detailed designs into accurate components that can quickly and easily be erected by a professional carpenter/builder.

RELATED PRODUCTS

Optional extras for our oak frame kits



GREEN OAK CLADDING

Feather Edge Cladding - 200mm x 24mm down to 7mm

Oak Cladding is the perfect finish to a timber-frame building. Growing environmental awareness amongst architects, developers, councils and self-builders has seen an increase in the use of timber for cladding. We provide attractive, economic and environmentally friendly cladding material of the highest standard.



OAK SHINGLES

Hand-split Oak - 400-450mm x 60-140mm x 16-22mm

Our oak shingles are produced from high-quality hand-split oak. All of our shingles are naturally durable, and do not require chemical treatment when used correctly. Once in place, our shingles will soften down to a silver grey.

For cladding, the shingles are doubled: 2m² of shingles to cover 1m². For roofing they are tripled - dependent on the slope of the roof & local weather conditions, between 2.5 & 2.7m² is required to cover 1m².



CEDAR SHINGLES

Hand-split Cedar - 400-450mm x 60-140mm x 16-22mm

Our cedar shingles are produced from high-quality hand-split oak. All of our shingles are naturally durable, and do not require chemical treatment when used correctly. Once in place, our shingles will soften down to a light-silver grey.

For cladding, the shingles are doubled: 2m² of shingles to cover 1m². For roofing they are tripled - dependent on the slope of the roof & local weather conditions, between 2.5 & 2.7m² is required to cover 1m².



STADDLE STONES

Yorkshire Stone - 195mm x 195mm x 230mm

To sit below the uprights of our timber frame kits, we have hand-cut Yorkshire Stone staddle stones available. All staddle stones come with a location steel imposition. Staddle stones are recommended for all garage kits, and are optional for gazebos and pergolas.

CLADDING & SHINGLES FITTING

Fitting guide for our specification cladding & shingles

GREEN OAK CLADDING

Feather Edge Cladding - 200mm x 24mm down to 7mm

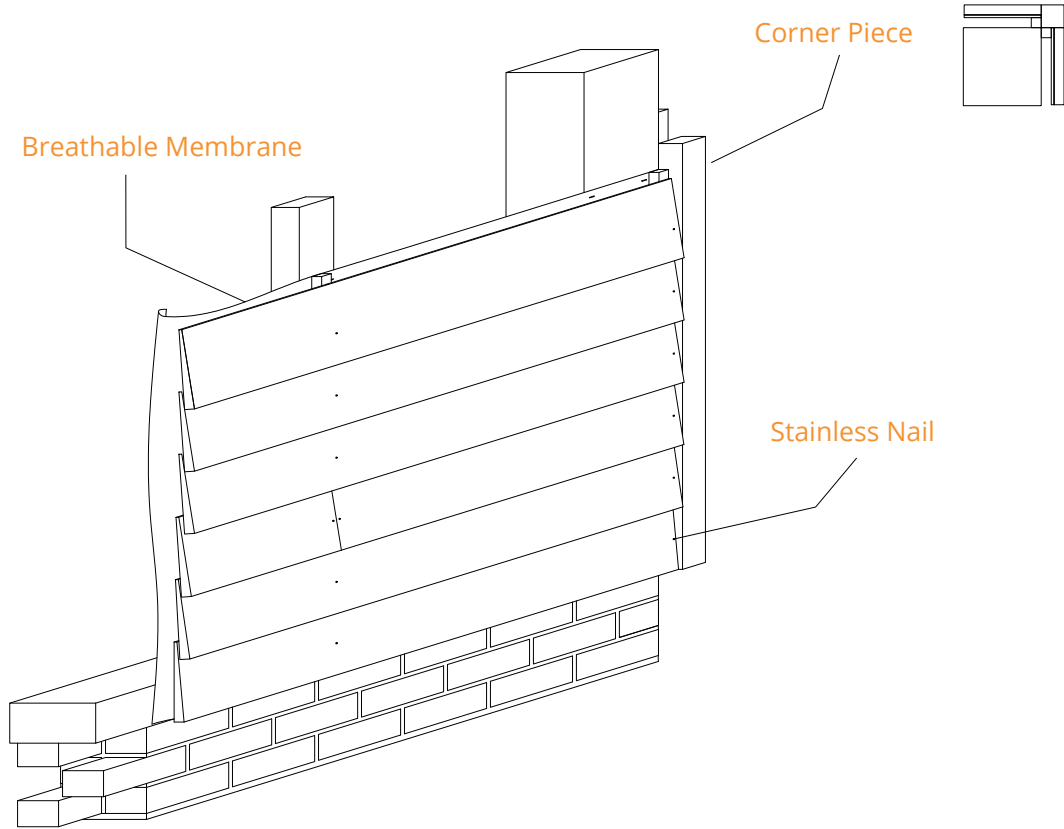

OAK & CEDAR SHINGLES

Oak/Cedar - 400-450mm x 60-140mm x 16-22mm

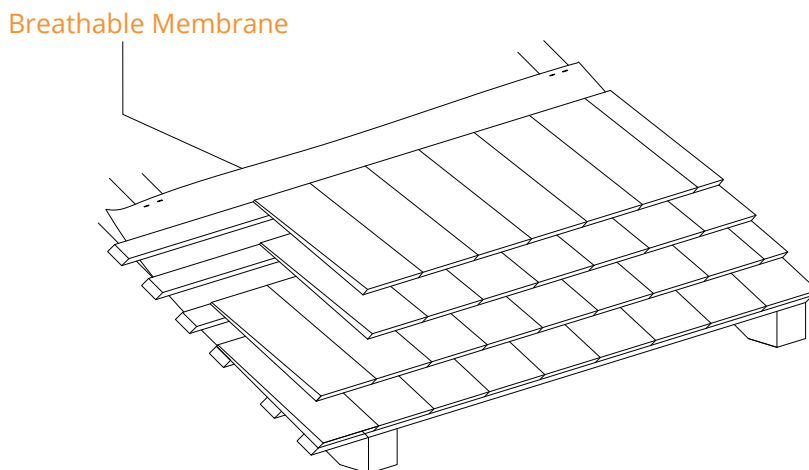

OPTIONAL LOG STORE

Left or right hand side kits available

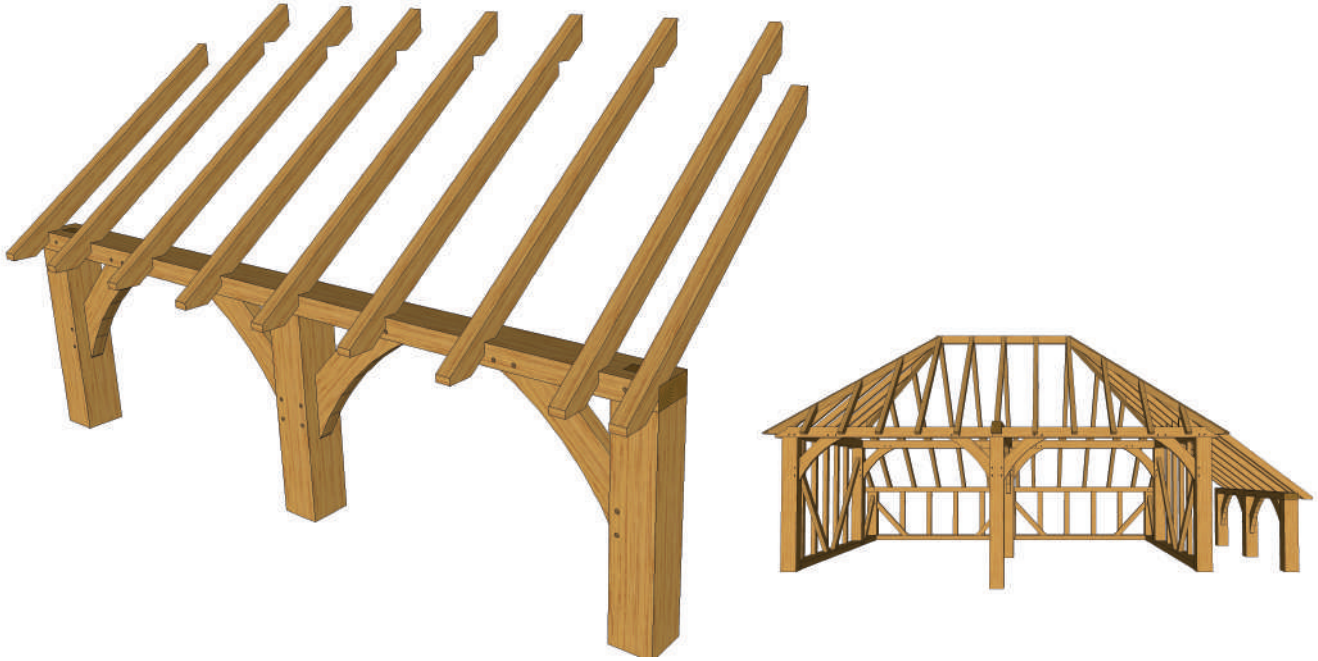

FRONT & SIDE ELEVATION

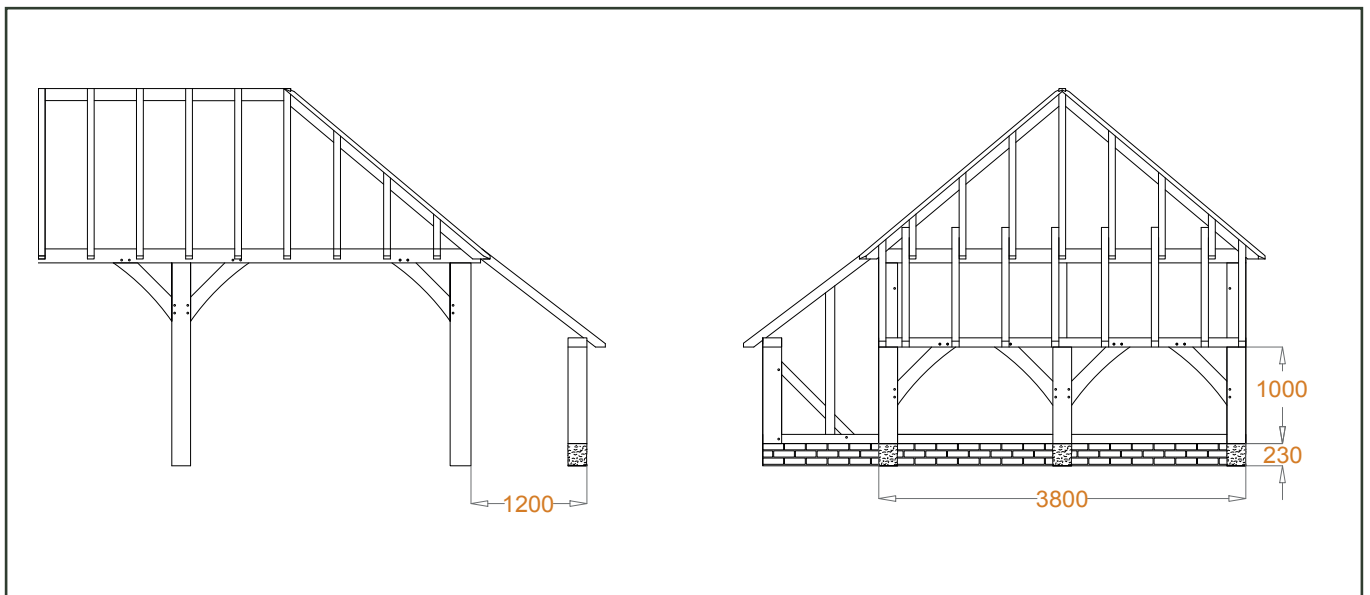

KIT SPECIFICATION

Dimensions include 230mm 3-course brick plinth

Height: 1330mm

Width: 1200mm

Depth: 3800mm

Oak Posts: 195mm x 195mm

Oak Head Plate: 100mm x 195mm

Oak Rafters: 95mm x 75mm

Timber Grade QP1 (D24)

DELIVERY & ASSEMBLY INFORMATION

Lifting equipment is strongly recommended

Lead-time: 4-6 weeks

Assembly Time: 0.5 days (2 man team)

Cladding Requirement*: 30 LM

Shingle Requirement*: 7m²

Batten Requirement*: 22 LM

*Calculated at our related product specifications and assuming both ends are clad.

ALTERNATIVE BASE FRAMES

List of Options Available



If you prefer to use softwood for some of the components of your frame, we are able to supply our garage kits with variations without studwork and roof components. We do not supply softwood, so you will have to source this timber locally.

ALTERNATIVE OPTION 1

No Roof + No Studwork

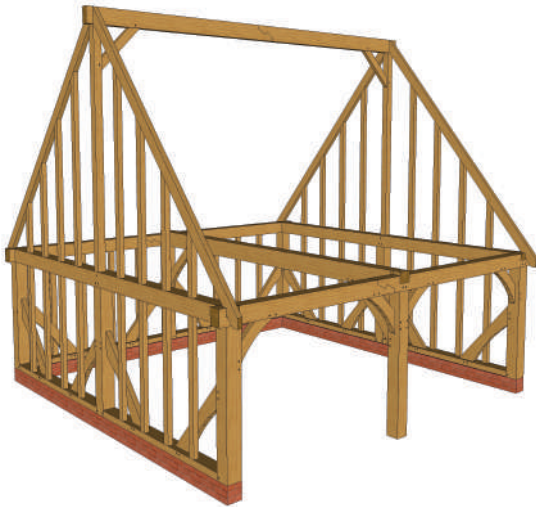

ALTERNATIVE OPTION 2

Ridgeboard + Principal Rafters + Includes Studwork
